



Heathside Court, Tadworth Street, Tadworth

The **PERSONAL** Agent

# £225,000

## Leasehold

- First floor apartment
- Lift access
- Large sitting-dining room
- Modern fitted kitchen
- Two double bedrooms both with cupboards
- Re-fitted shower room
- Several large storage cupboards
- Double glazing and gas central heating
- Residents parking
- No onward chain

A two bedroom first floor retirement apartment with lift access. The property has spacious room sizes throughout and gas central heating. Attractive communal gardens, day warden and residents parking.

A two bedroom first floor retirement apartment with lift access. The property has spacious room sizes throughout and gas central heating. Attractive communal gardens, day warden and residents parking.



This spacious first floor flat is situated within a sought after retirement development for the over 55's. The property has lift access. Attractive communal gardens and day warden. The accommodation comprises: Spacious entrance hall with several storage cupboards, very good size sitting-dining room with nice outlook, modern fitted kitchen, Two double bedrooms both with cupboards and updated fitted shower room.

Gas central heating and double glazing. Residents parking. Ideally situated within easy walking distance of the village with its excellent local shops, restaurants and cafe's. Tadworth train station has a direct link with London Waterloo, there are also several bus stops within easy reach. No onward chain.



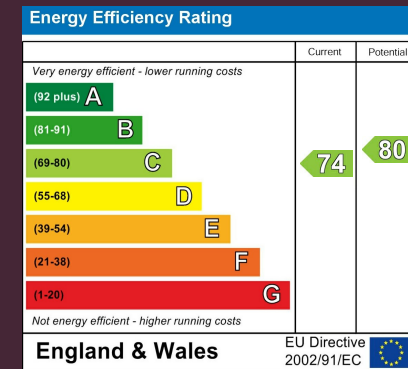
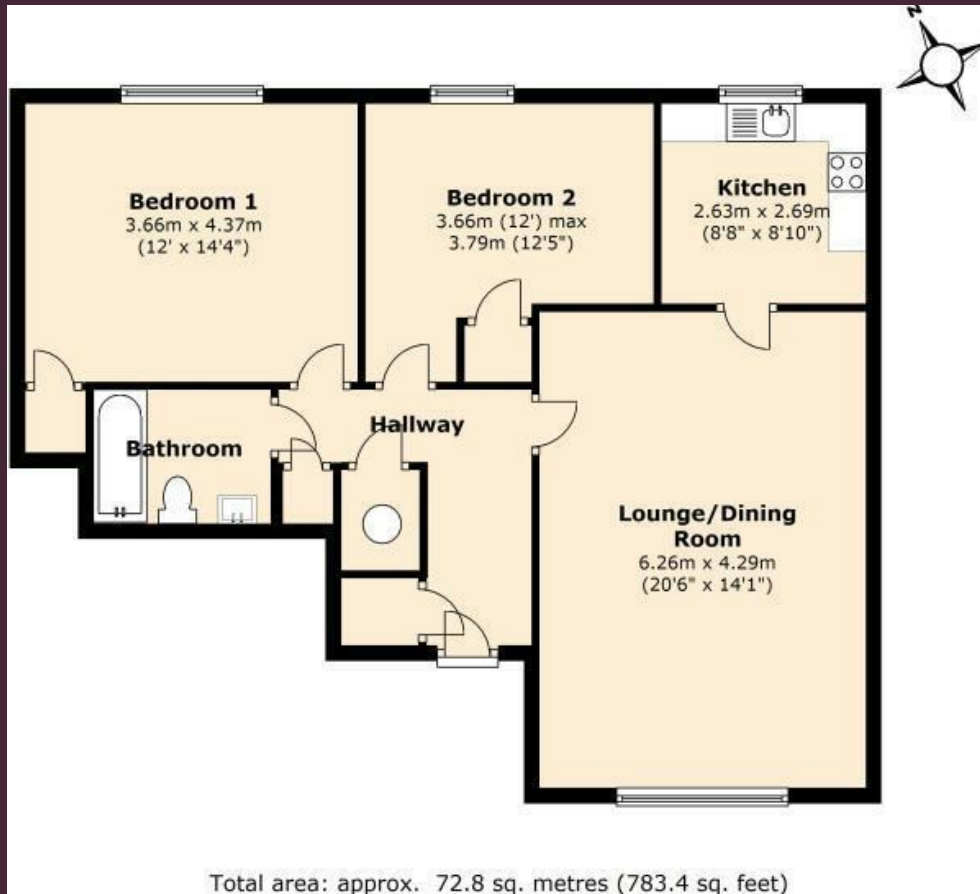

**EPSOM OFFICE**  
2 West Street  
Epsom, Surrey, KT18 7RG  
01372 745 850

**STONELEIGH/EWELL OFFICE**  
62 Stoneleigh Broadway  
Stoneleigh, Surrey, KT17 2HS  
020 8393 9411

**BANSTEAD OFFICE**  
141 High Street  
Banstead, Surrey, SM7 2NS  
01737 333 699

**TADWORTH & KINGSWOOD OFFICE**  
Station Approach Road  
Tadworth, Surrey, KT20 5AG  
01737 814 900

**LETTINGS & MANAGEMENT**  
157 High Street  
Epsom, Surrey, KT19 8EW  
01372 726 666



The Personal Agent Ltd. Registered office: 2A Boston Rd, Henley-on-Thames RG9 1DY.  
Registered in England No. 4398817.



**Please Note:** Whilst every attempt has been made to ensure the accuracy of the floorplans contained here, measurements of doors, windows and room areas are approximate and no responsibility is taken for any error, omission or mis-statement. These plans are for representation purposes only and should be used as such by and prospective purchaser. The services, systems and appliances listed in the specification have not been tested by The Personal Agent and no guarantee as to their operating ability or their efficiency can be given. All images and text used to advertise our properties are for the sole use of The Personal Agent Ltd.